



773 SF AVAILABLE IN FRY'S GROCERY ANCHORED CENTER

SWC OF 35TH AVE & PEORIA AVE | PHOENIX, AZ

JENNIFER HILL

Vice President of Leasing and Sales

602.616.4477

jhill@gpsaz.com



PROPERTY HIGHLIGHTS

- Fry's Grocery anchored shopping center
- Last suite available in multi-tenant building
- Former insurance office
- Co-tenants include Bosa Donuts, Phoenix Nail Salon, Steak Taco, Buddy's Home Furnishings, AM/PM and Taco Bell and My Dr. Now is under construction
- Other retailers at this intersection include Salad & Go, Panda Express, McDonald's, Planet Fitness, Eyeglass World, Boost Mobile, and Circle K
- 1 mile west of I-17 Freeway
- Excellent visibility and easy access with monument signage available

2023 DEMOS (3-MILE RADIUS)

TOTAL POPULATION **183,201**

DAYTIME POPULATION **153,890**

TRAFFIC COUNTS

PEORIA AVE **51,480 VPD**

(ADOT '22)

35TH AVE **35,267 VPD**

(ADOT '22)

773 SF AVAILABLE IN FRY'S GROCERY ANCHORED CENTER

SWC OF 35TH AVE & PEORIA AVE | **PHOENIX, AZ**



SITE PLAN

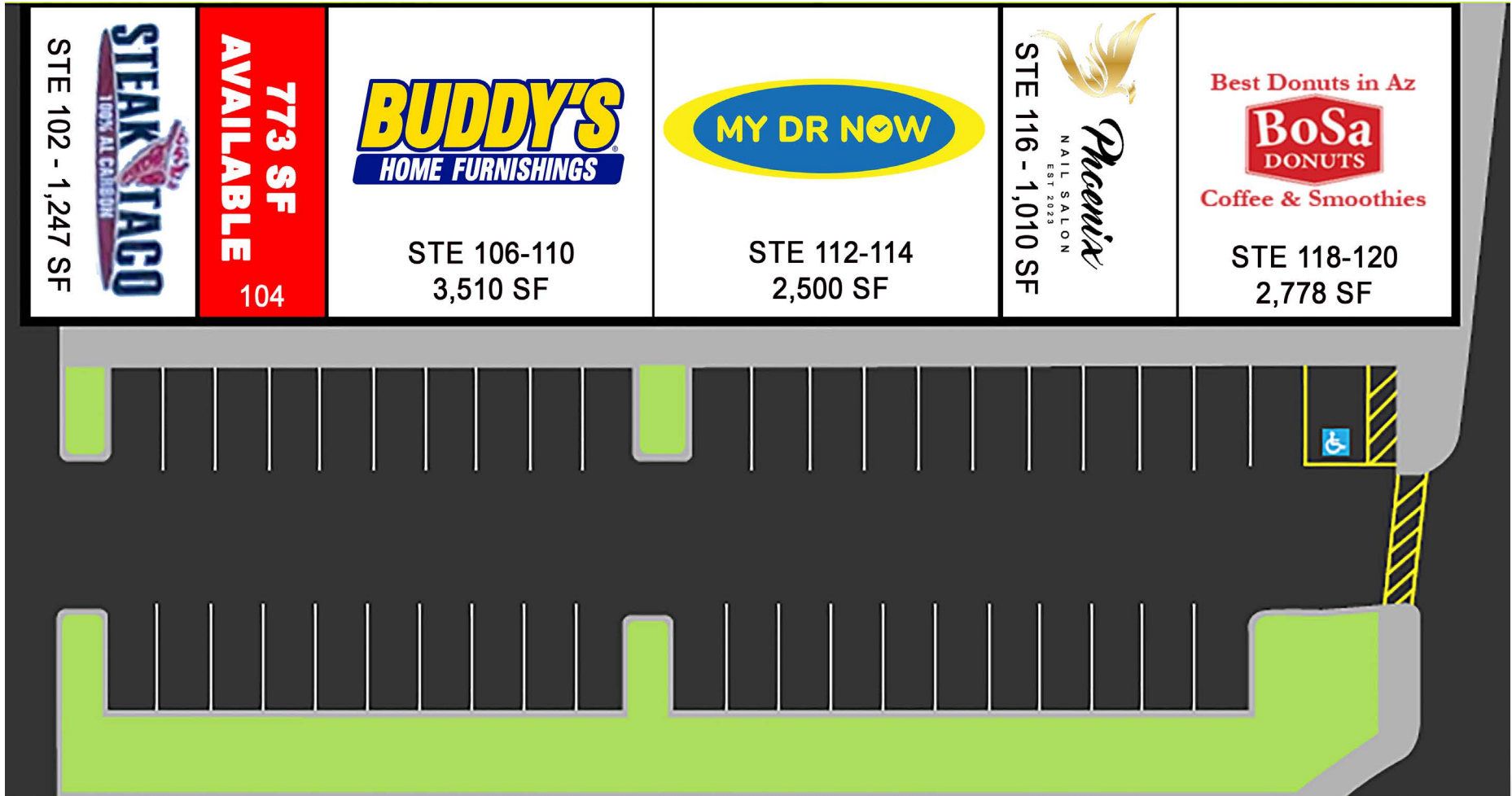

35TH AVE **35,267 VPD** (ADOT '22)



773 SF AVAILABLE IN FRY'S GROCERY ANCHORED CENTER

SWC OF 35TH AVE & PEORIA AVE | **PHOENIX, AZ**



PROPERTY PHOTOS



773 SF AVAILABLE IN FRY'S GROCERY ANCHORED CENTER
SWC OF 35TH AVE & PEORIA AVE | **PHOENIX, AZ**

DRONE VIEW



773 SF AVAILABLE IN FRY'S GROCERY ANCHORED CENTER
SWC OF 35TH AVE & PEORIA AVE | **PHOENIX, AZ**

RETAIL AERIAL



773 SF AVAILABLE IN FRY'S GROCERY ANCHORED CENTER
 SWC OF 35TH AVE & PEORIA AVE | **PHOENIX, AZ**

MARKET AERIAL

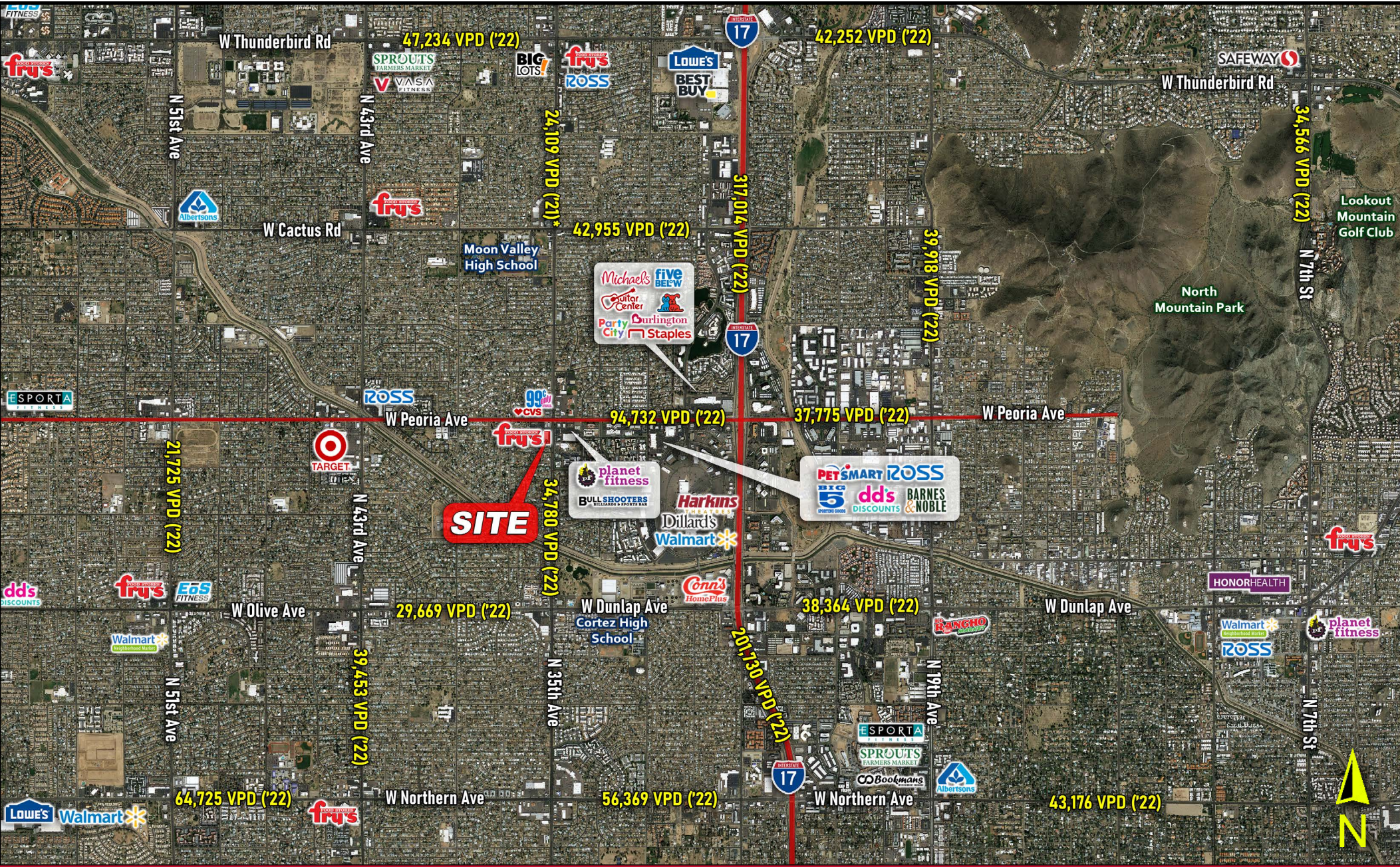

773 SF AVAILABLE IN FRY'S GROCERY ANCHORED CENTER

SWC OF 35TH AVE & PEORIA AVE | **PHOENIX, AZ**

DEMOGRAPHIC SNAPSHOT



2023 Total Population

1 MILE	3 MILE	5 MILE
19,394	183,201	452,730

2028 Total Population

19,029	180,637	448,035
--------	---------	---------



Average HH Income

1 MILE	3 MILE	5 MILE
\$75,838	\$77,140	\$84,587

Median HH Income

\$57,594	\$56,222	\$69,465
----------	----------	----------



Daytime Employees

1 MILE	3 MILE	5 MILE
7,764	57,834	153,517

Daytime Residents

10,263	153,890	394,995
--------	---------	---------



2023 Households

1 MILE	3 MILE	5 MILE
7,331	66,898	164,236

2028 Households

7,226	66,508	163,958
-------	--------	---------



Owner Occupied Housing

1 MILE	3 MILE	5 MILE
48.7%	50.1%	52.3%

Renter Occupied Housing

47.0%	50.1%	52.3%
-------	-------	-------



2023 Median Age

1 MILE	3 MILE	5 MILE
36.6	35.0	35.2

2028 Median Age

37.2	35.8	35.9
------	------	------

773 SF AVAILABLE IN FRY'S GROCERY ANCHORED CENTER

SWC OF 35TH AVE & PEORIA AVE | **PHOENIX, AZ**